

CETOP 3: Side Entry Subplate

Features:

- Cast Iron Construction – Phosphated
- 345 Bar Maximum Working Pressure
- 3/8" BSP Ported

Benefits:

- Reduced Fitting and Installation Costs
- Compact design of valve circuits
- Reduces leak Paths

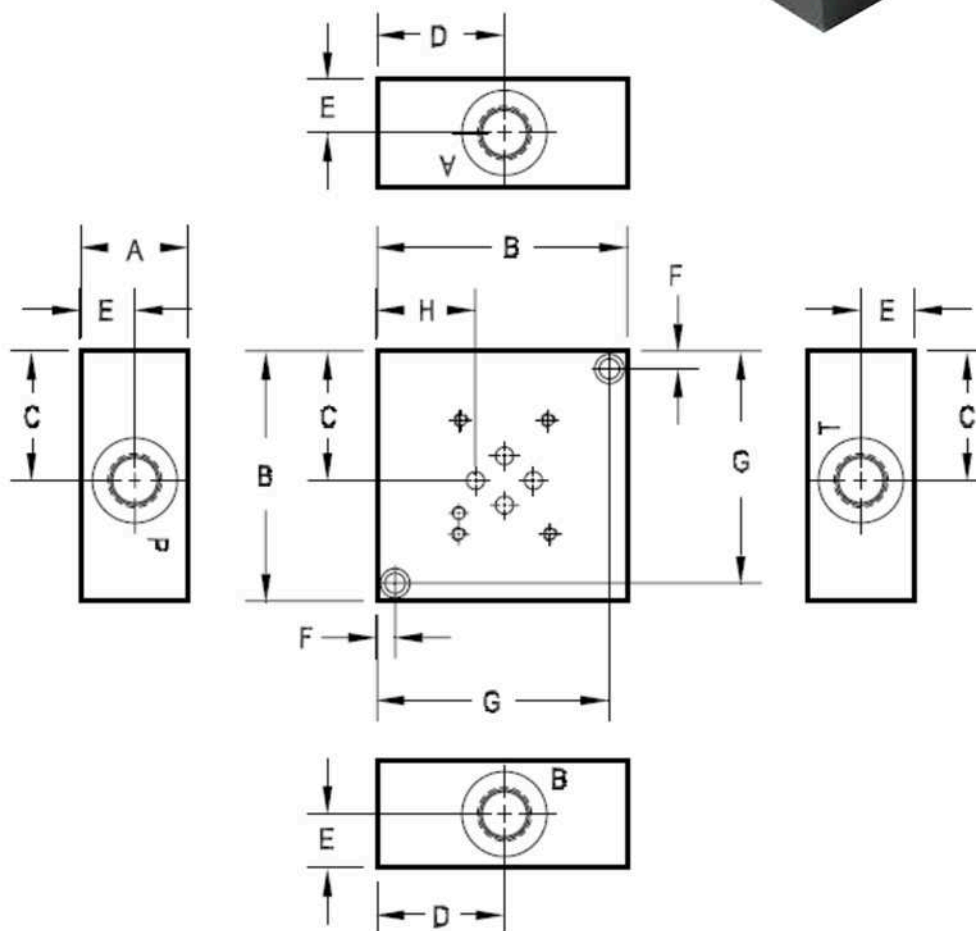

Part Number	A (mm)	B (mm)	C (mm)	D (mm)	E (mm)	F (mm)	G (mm)	H (mm)
B-SE3-G	24.5	63.5	33.3	31.8	12.7	6.4	57.2	22.4

We offer a Full Range of Hydraulic Products from a comprehensive range of manufacturers to bring you the products and systems most suited to your applications

