

## NRVSS - Non-Return Valves Valves

### NRVSS SERIES

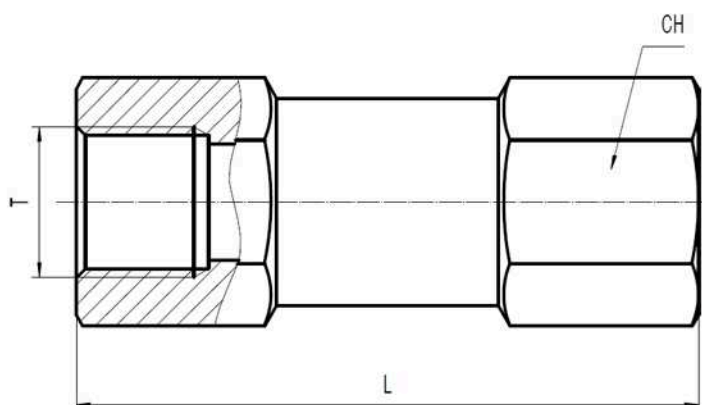

Art.No.	Max.Working Pressure	L	CH	T
HCVSS-38	350	70	24	3/8"BSPP
HCVSS-12	350	87	32	1/2"BSPP
HCVSS-34	350	95	36	3/4"BSPP
HCVSS-1	350	125	42	1"BSPP

#### Technique data:

- 1, Standard material: stainless steel 316
- 2, Temperature Range: -40° C-150° C
- 3, Standard crack: 0.35bar— 0.5bar