

HYDRAULIC CHAIN CUTTERS

THE ONE STOP HYDRAULIC & PNEUMATIC SHOP

HYDRAULICS2U.CO.UK

sales@hydraulics2u.co.uk

02392 607060



Special applications.



Model	Capacity	Weight	A	B	C	D	L	Chain	Strength by grades	Standards	Bar	Strength
	kN	kg	mm	mm	mm	mm	mm	Ø max. mm			Ø max. mm	N/mm ²
MC-L-16C	135	5,1	81,5	54	20	68	489	19	28-43-50	ASTM-413 DIN 5684	19 15	700 1.000
								14	60-80	DIN 5685 DIN 764	13 11	1.400 1.600
RC-L-116C	135	4,5	81,5	54	20	68	290	19	28-43-50	ASTM-413 DIN 5684	19 15	700 1.000
								14	60-80	DIN 5685 DIN 764	13 11	1.400 1.600
RC-L-130C	390	15,6	183	88	32	113	360	30	28-43-50	ASTM-413 DIN 5684	30 - 25 20 - 17	700 - 1.000 1.400 - 1.600
								20	60-80	DIN 766 DIN 762	30 - 25 20 - 17	700 - 1.000 1.400 - 1.600
RC-L-230C	345	16	183	88	32	113	360	30	28-43-50	ASTM-413 DIN 5684	30 - 25 20 - 17	700 - 1.000 1.400 - 1.600
								20	60-80	DIN 766 DIN 762	30 - 25 20 - 17	700 - 1.000 1.400 - 1.600
RC-L-250C	1.120	80	228	120	51	206	475	50	28-43-50	DIN 5684	50 - 45 40 - 35	700 - 1.000 1.400 - 1.600
								40	60-80	DIN 685	50 - 45 40 - 35	700 - 1.000 1.400 - 1.600

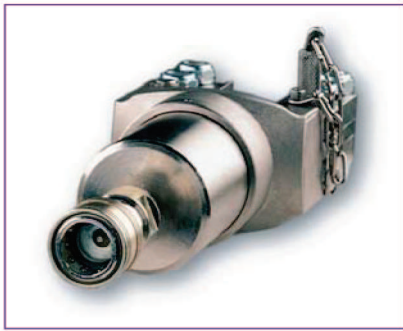

All models are supplied with a male ball quick coupler



> Maximum working pressure 700 bar.

MC-L-16C

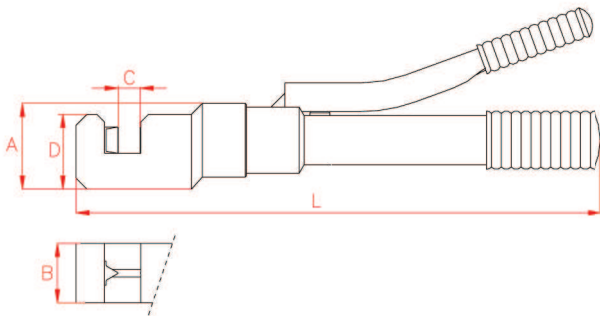

RC-L-116C and RC-L-130C

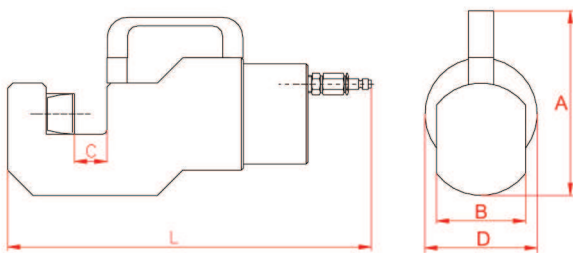

RC-L-230C and RC-L-250C

